



61806-2RZ Deep groove ball bearings

- Popular item

Deep groove ball bearings

Bearing data

[Tolerances](#),

Normal (metric), P6, P5, Normal (inch),

[Radial internal clearance](#),

Matched bearing pairs, Stainless steel
d < 10 mm, Other bearings

Bearing interfaces

[Seat tolerances for standard conditions](#),

[Tolerances and resultant fits](#)

Technical specification

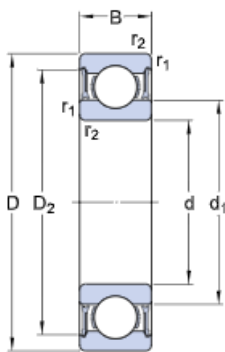

DIMENSIONS

d	30 mm	Bore diameter
D	42 mm	Outside diameter
B	7 mm	Width
d ₁	≈ 33.7 mm	Shoulder diameter
D ₂	≈ 39.4 mm	Recess diameter
r _{1,2}	min. 0.6 mm	Chamfer dimension

ABUTMENT DIMENSIONS

d _ε min.	32 mm	Diameter of shaft abutment
d _ε max.	33.6 mm	Diameter of shaft abutment
D _i max.	40 mm	Diameter of housing abutment
r _a max.	0.3 mm	Radius of shaft or housing fillet

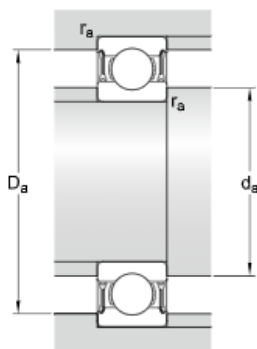

CALCULATION DATA

C	4.49 kN	Basic dynamic load rating
C ₀	2.9 kN	Basic static load rating
P _u	0.146 kN	Fatigue load limit
	32 000 r/min	Reference speed
	16 000 r/min	Limiting speed
k _r	0.015	Minimum load factor
f ₀	13.9	Calculation factor

MASS

	0.025 kg	Mass bearing
--	----------	--------------

TOLERANCE CLASS

Normal	Dimensional tolerances
Normal	Radial run-out